

23/01154/FUL

Arrow Valley Park, Battens Drive, Redditch B98 0LJ

Installation of a Pump Track between existing BMX facility and Skate Park

Recommendation: grant subject to conditions

Site Location

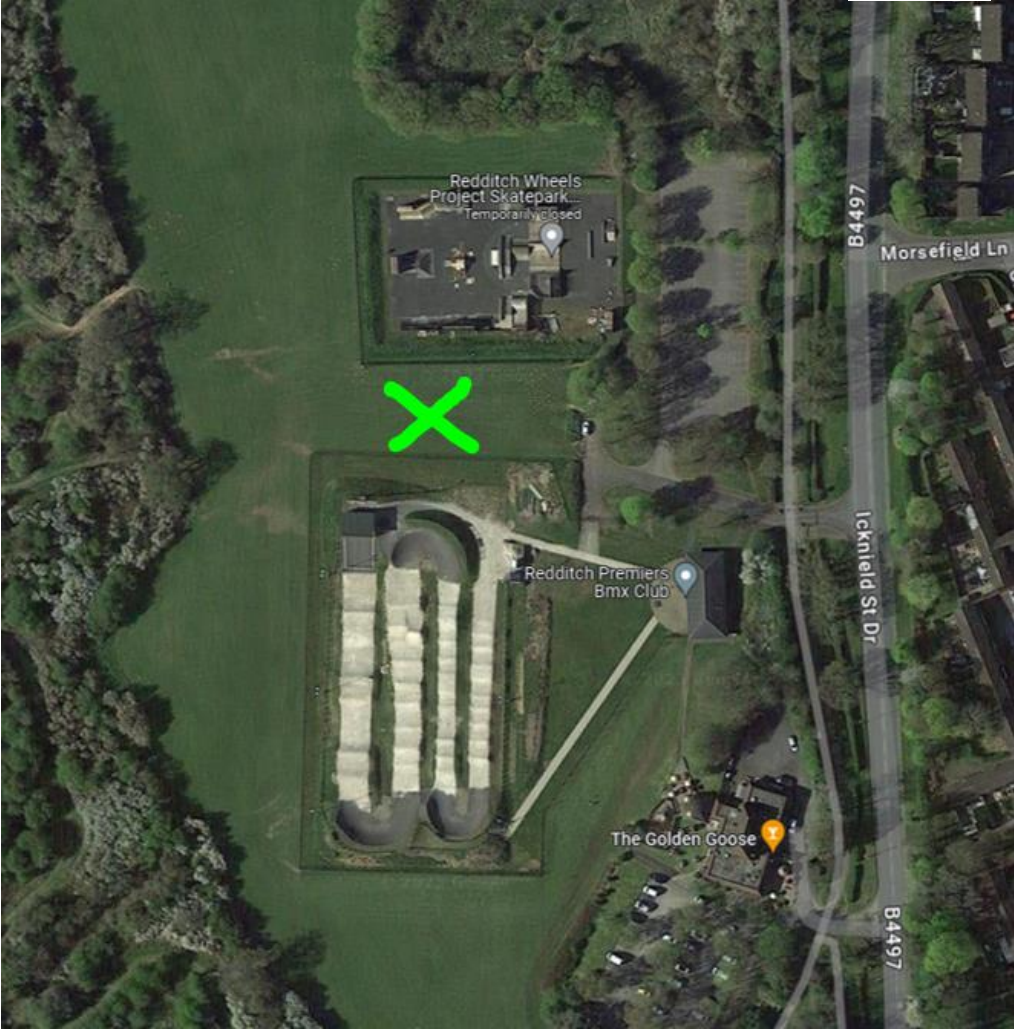
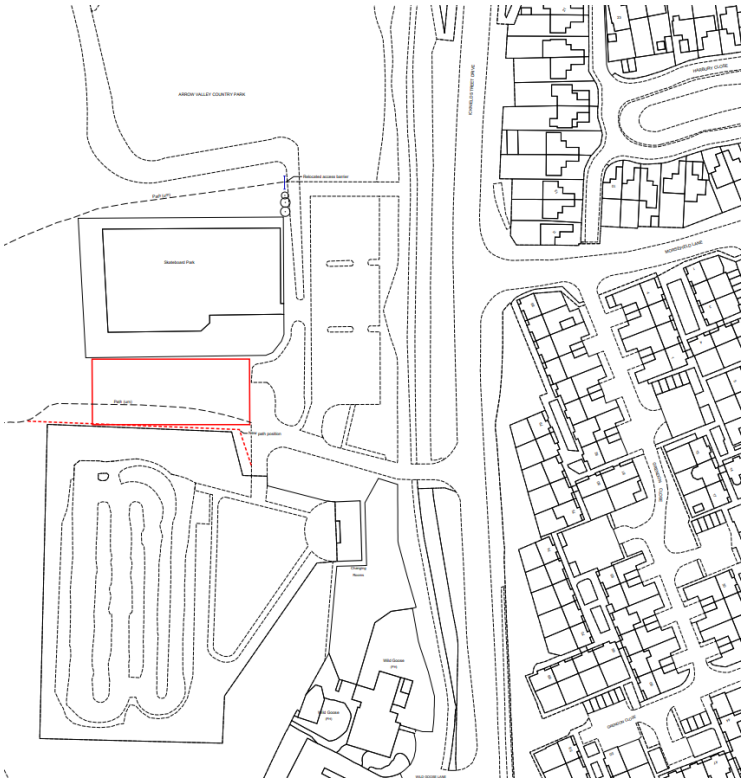

Layout Plan

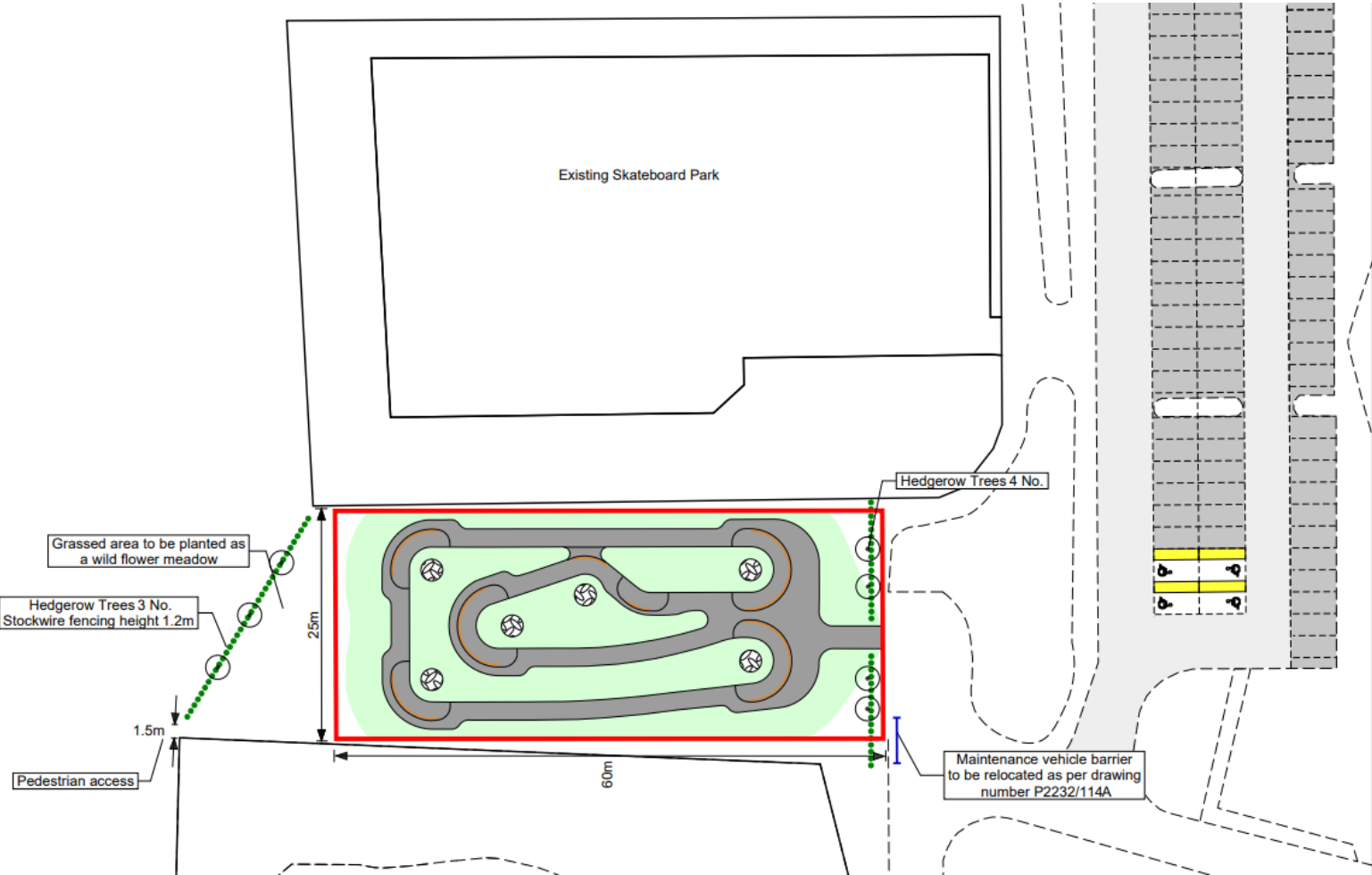

Key

- Planning application boundary
- Landscaped Area
- Asphalt Area
- Safety Line/ Turn in direction
- Cellular Soakaway (SuDS)

Note
Refer to Clark & Kent Contractors for detailed drawings

22/11/2023			A			Revised location of the Pump Track		
Date	Rev	Details						

Project:

**Proposed Pump Track Development
Arrow Valley Country Park**

Drawing:

**Pump Track Layout Plan
(Planning Application)**

Drawn: JH	Scale: 1/500 @ A3
Surveyed: OS	Date: Oct 2023

Drawing No: **P2232/120A**

Engineering and Design Services
Town Hall
Walter Stranz Square
Redditch
Worcs B96 8AH

Concept plan and sections

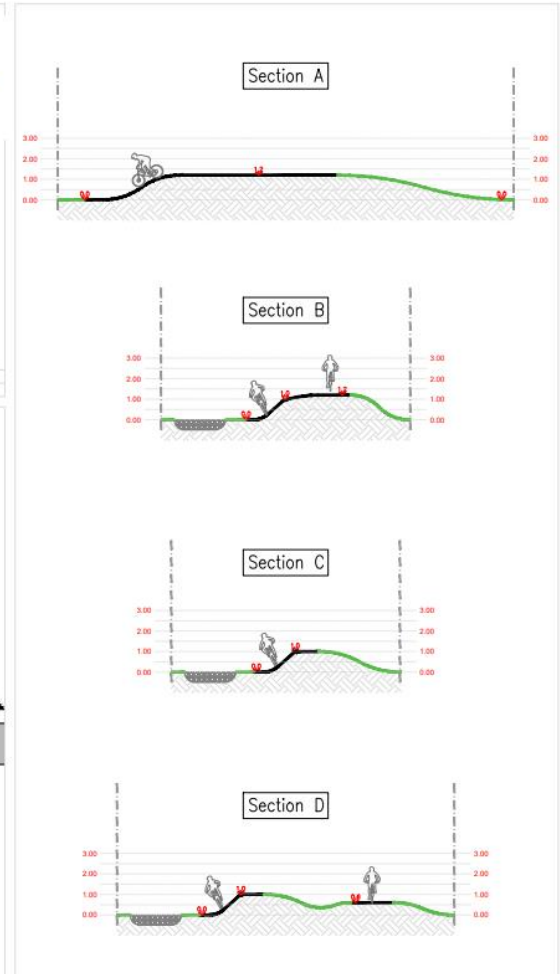
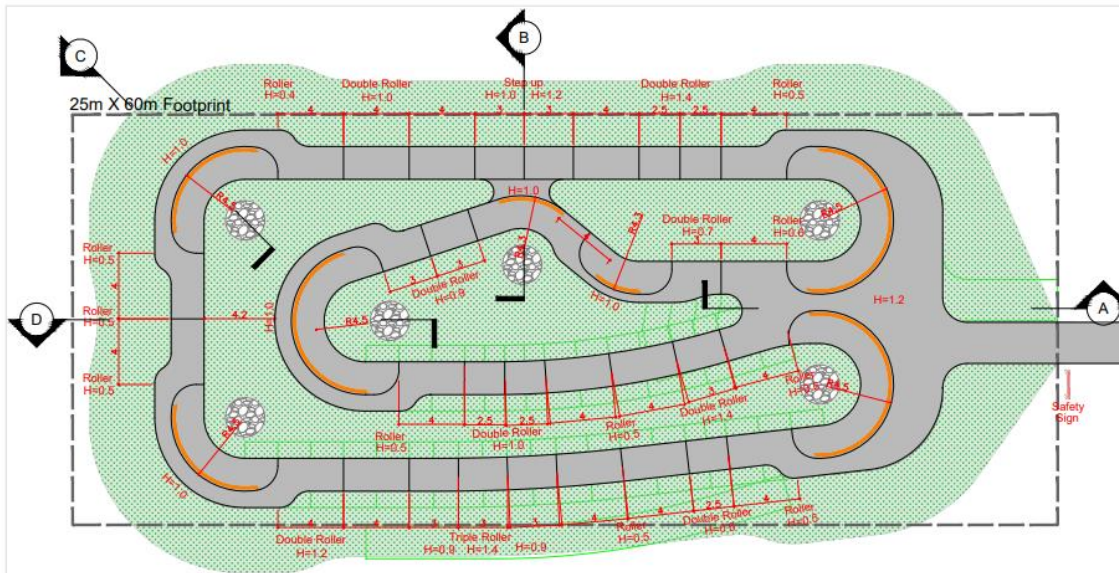

Notes: Asphalt Surface area (2D)
560 sqM
(including footpath to carpark area)

Drainage details

Side Elevation

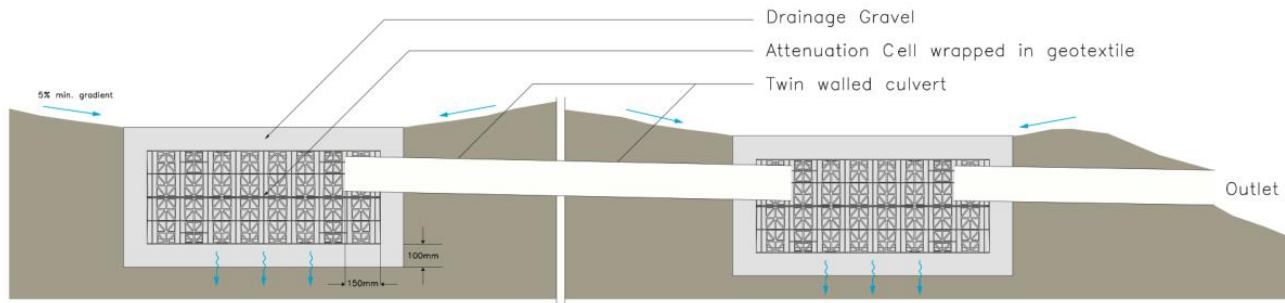

Plan View

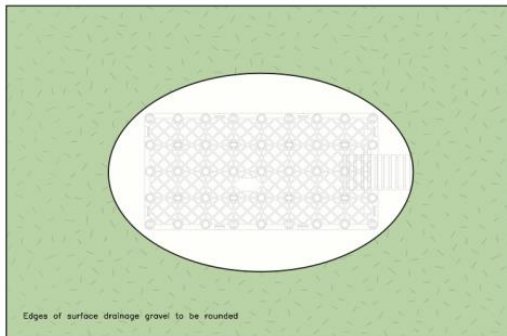

Isometric View

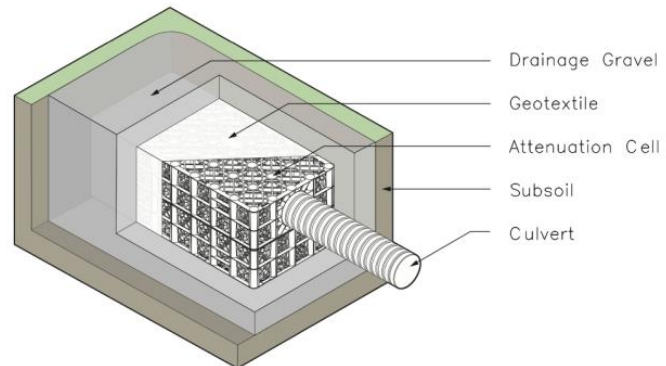

Access from Ickniel Street Drive



Images of site



Car park serving site



Riders at a typical pump track

